



Clever

<https://www.clever.com/>

How to login and use Clever

What is Clever?

Clever is a platform that allows students to have one location to find everything they need for educational purposes. It requires your student's school information to sign in and access these resources.

Instructions

1. First, hover over the blue “Log in as a student” sign
2. Click “Student”

The screenshot shows the Clever website interface. At the top right, there is a blue button labeled "Log in as a student" with a dropdown arrow. A green arrow points to this button with the instruction "1. Hover Over The 'Log in as a student'". A dropdown menu is open, showing options: "Student", "Parent or Guardian", "Teacher or Staff", "District Admin", and "Application Partner". A second green arrow points to the "Student" option with the instruction "2. Next click on 'Student'". The main content area features the Clever logo, navigation links (Schools, Application Partners, Apps On Clever, Our Company, Help), and a large heading "The platform powering digital learning for schools." Below the heading is a sub-heading "At Clever, we securely connect the data and applications that schools rely on to make digital learning work better for everyone." and a "Log in as a student" button. At the bottom, there are two buttons: "For schools" and "For application partners". A small image of a smiling student is visible on the right side of the page.

3. Type in your school name in the text box
4. Click on your correct school

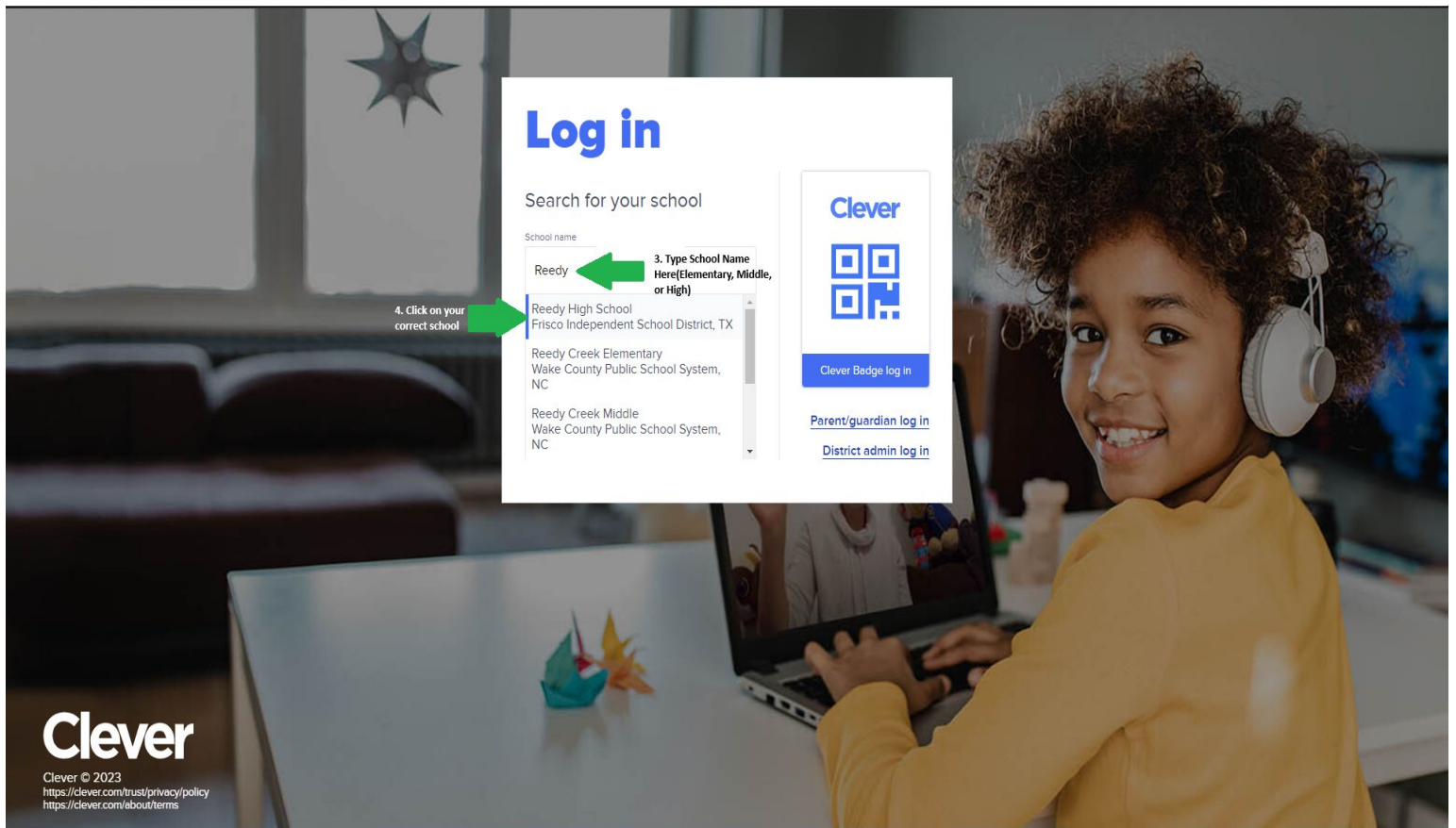

Tip: Look for the correct school district for your school

5. Click the "Log in with Google" sign

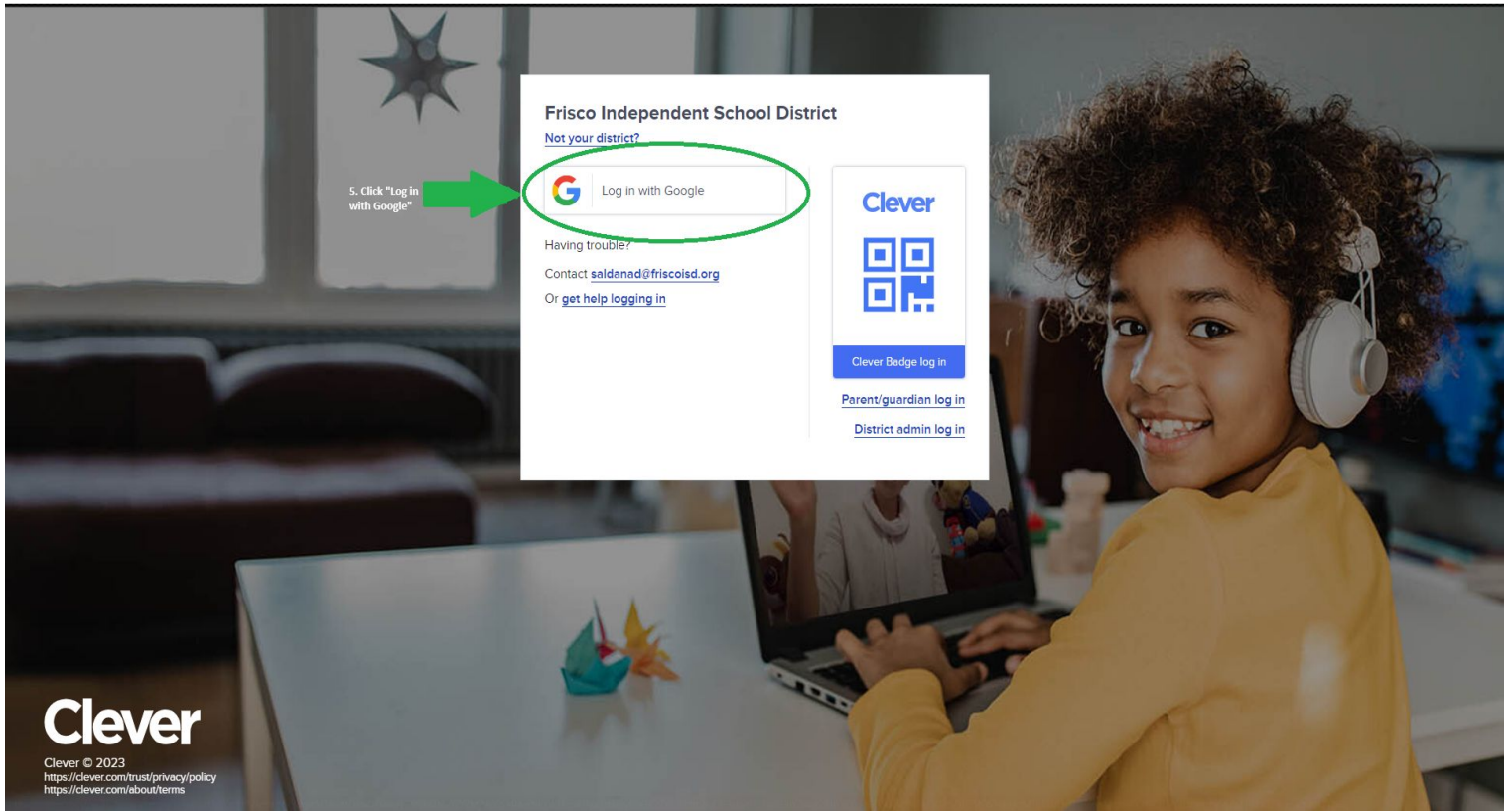

5a. Click the "Log in with a different account" button if you get this message

5b. Sign in with your SCHOOL EMAIL and password if you get this pop-up

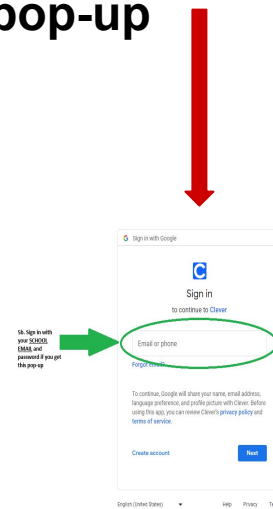

6a. You can click the heart symbol on a resource to favorite it

6b. You can use the search bar to search for any educational resources

6c. You can click on the bell button for notifications

The screenshot shows the Clever Portal interface. At the top, there is a blue header with the Clever logo on the left, a search bar in the center, and a bell icon for notifications on the right. Below the header, the main content area is divided into sections: Favorite resources, Teacher Pages, District Wide, Elementary, and Secondary. The Favorite resources section displays four resource cards: Mastery Connect, MackinVIA, BrainPOP, and Nearpod. The Teacher Pages section shows five owl icons, with a green arrow pointing to the third one and the text "6a. You can click on this heart to favorite a resource". The District Wide section shows five resource cards: Discovery Education, MackinVIA, Mastery Connect, Nearpod, and STEMscopes SSO and Rostering. The Elementary section shows one resource card: BrainPOP. On the left side, there is a vertical navigation menu with a green box around it and a green arrow pointing to it with the text "6c. You can click any of these to navigate to a section". In the top right corner, there is a search bar with a green box around it and a green arrow pointing to it with the text "6b. You can use the search bar to search for any educational resources", and a bell icon with a green arrow pointing to it and the text "6c. You can click on this for notifications".

**Congratulations! You are now ready to use
Clever!**